

New Products Catalog during the Pandemic

PROVIDE SAFETY ENVIRONMENT FOR YOU

TABLE OF CONTENTS

INTRODUCTION

ESCALATOR SPARE PARTS

ESCALATOR HANDRAIL CLEANING MACHINE GS00101003

ESCALATOR STEP CLEANING MACHINE GS00101004

GESTURE CALL DS00101001

ELEVATOR PLASMA AIR PURIFIER DS00101003

ELEVATOR AIR STERILIZER DS00101004

ELEVATOR ULTRAVIOLET

DISINFECTION SYSTEM DS00101005

INTRODUCTION

Technological innovation has never stopped during special period. K ELEVA- TORS Installation and Maintenance are following the footsteps of technologi- cal innovation and have been looking for solutions to enable our customers to take escalators or elevators more safety, to avoid bacterial or virus infection. We will share eight new products which used for escalators and elevators.

ESCALATOR SPARE PARTS HANDRAIL LED UVC STERILIZER GS00101001

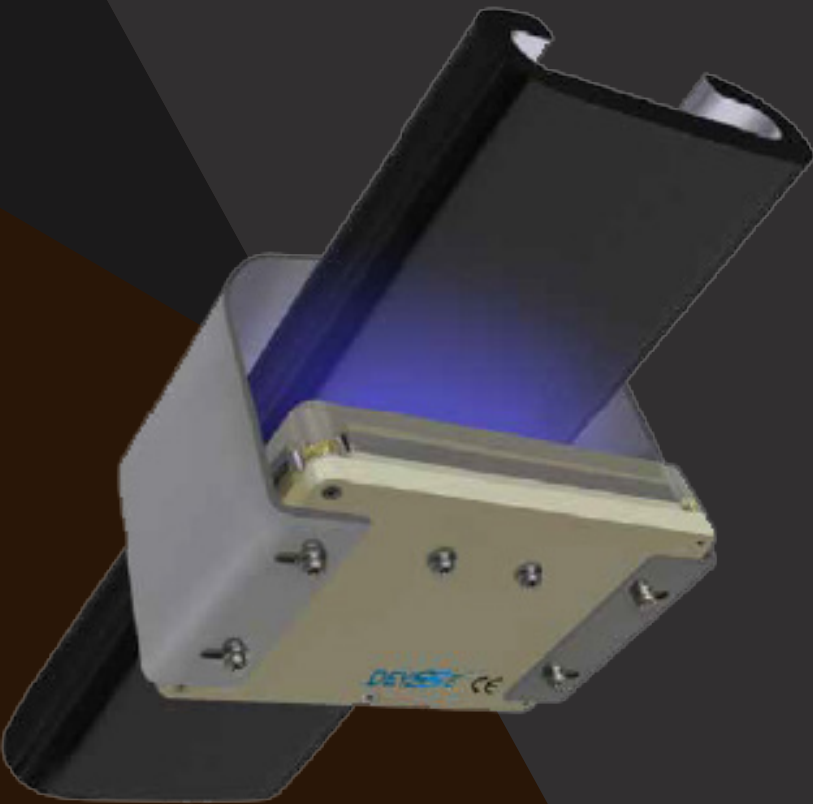

Principle: Ultraviolet can be divided into long wave,medium wave and short wave according to the wavelength. The short wave ultraviolet has the bacteri- cidal effect, which is generally 200-275mm range is the best waveband for sterilization. The principle of the UCV sterilization method is to damage the molecular structure of microbial cell's (bacteria, virus and other pathogens) DNA and RNA.

EXOLODED DRAWINGS FOR COMPONENTS

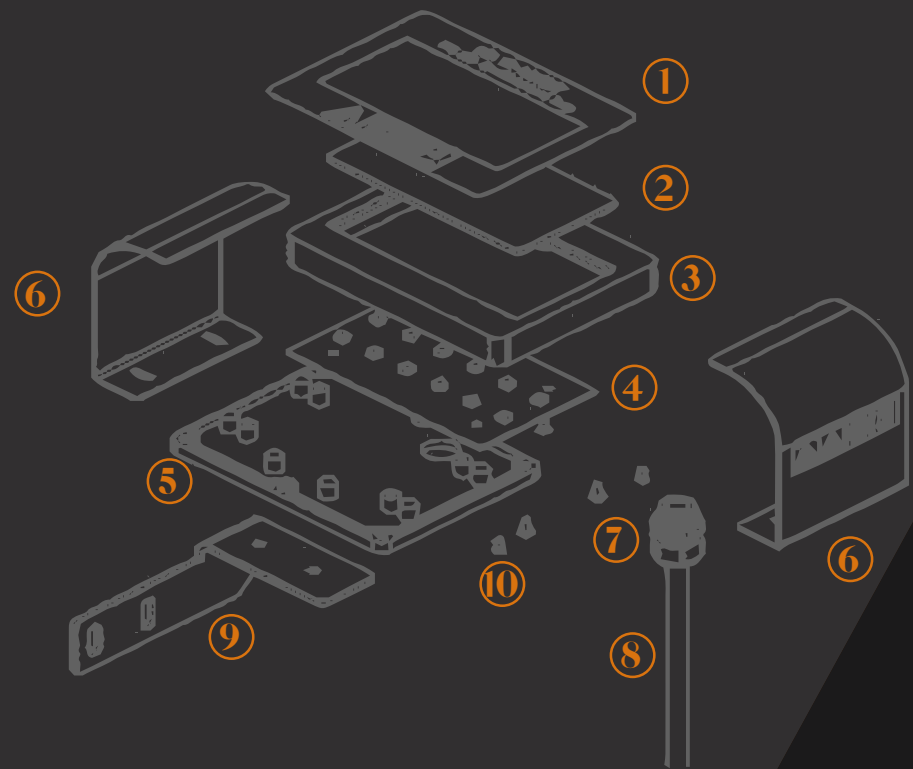

MAIN DATA



12.0.3W



DC24V



IP 55

COMPONENT

ID	QUANTITY	ARTICLES
1	1	PVC Thin Film
2	1	Quartz Glass
3	1	Front Cover
4	2	PCB Board
5	1	Rear Cover
6	1	Reflector
7	1	Cable Connector
8	1	Cable
9	1	Installation Bracket
10	4	Fastening screw

TECHNICAL PARAMETERS:

Input	DC24V±10%
Input Vurrent	<0.15A
Wave Length	270~285nm
LED Size	3535
LED Quantity	12PCS
Design Lifetime	10000hrs
IP Protecting Level	IP55
Working Temperature	-25℃ ~ +60℃
Operation Relative Humidity	≤95%
Storage Environment	-30℃~ +70℃
Best Sterilization Distance	≤25mm(Vertical distance between light emitting surface of lamp and handrail)
Irradiation area	100*50mm
Initial Irrrandiance	≥45uw/cm2(@15mm)
Irrrandiance@10000Hrs	≤40uw/cm2(@15mm)
Matenial	PC & SUS304 & Quartz Glass
Off and On time	>300,000 times

INSTALLATION

The UVC sterilization lamp is installed inside an escalator.Choose an available space where the lamp can be fxed in handrail system.

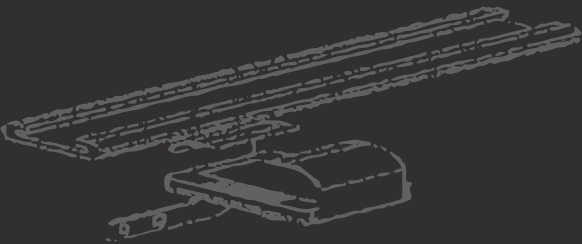

Step 1

Put the refector of lamp go through the handrail, which makes the luminous surface of lamp faces to the handrail.

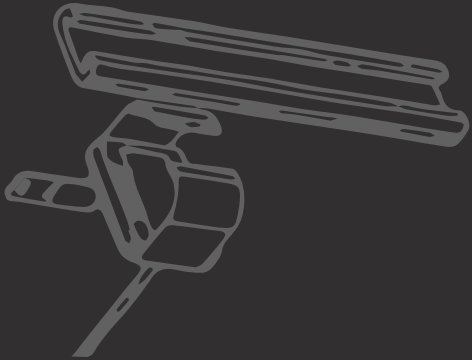

Step 2

Choose a suitable installation bracket, and fx the lamp into the target position.

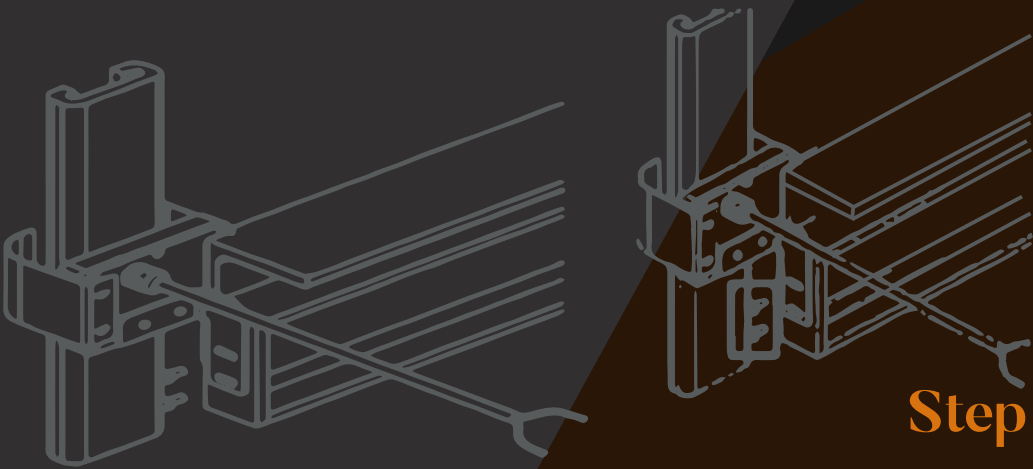

Step 3

Adjust the lamp via two installation holes of bracket, and be sure the distance between the handrail and lamp is 10~15mm, which brings the sterilization effect.

PHOTOS:

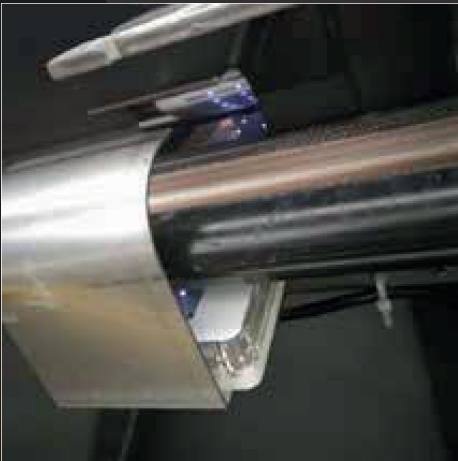
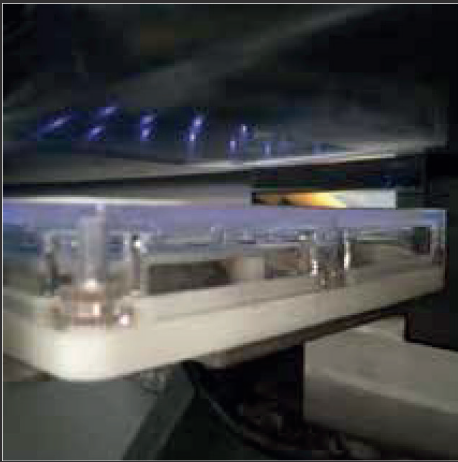
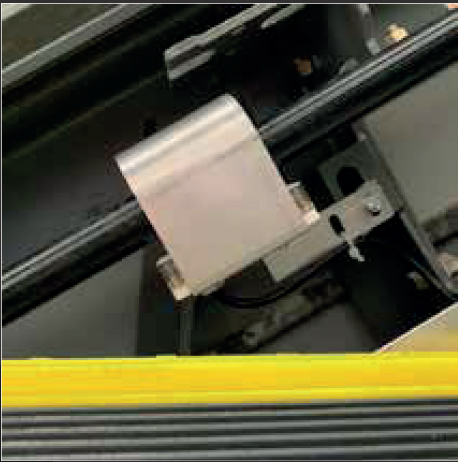

CERTIFICATION: CE; SGS

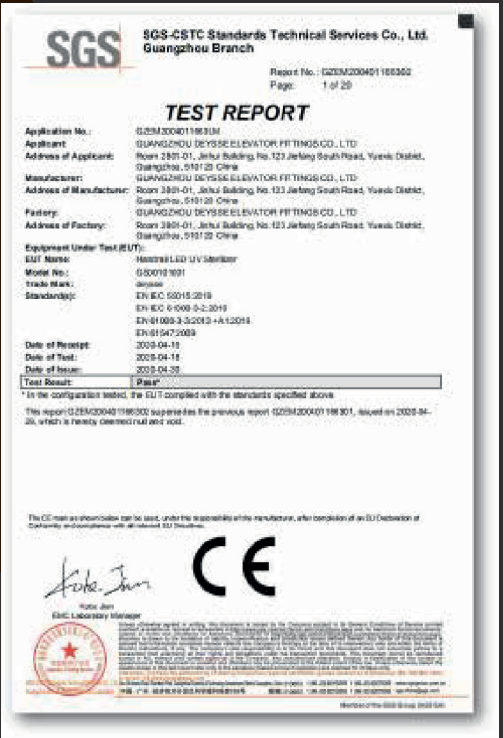

ESCALATOR HANDRAIL CLEANING MACHINE GS00101003



INTRODUCTION:
Escalator handrail cleaning machine is a non-motorized, simple and practical cleaning device. The use of engineering rubber brackets, equipped with negative microfiber cleaning pads, combined with high-efficiency disinfectant, on the premise of extending the rubber life of the armrest, remove dirt and bacteria, and has a disinfection effect.

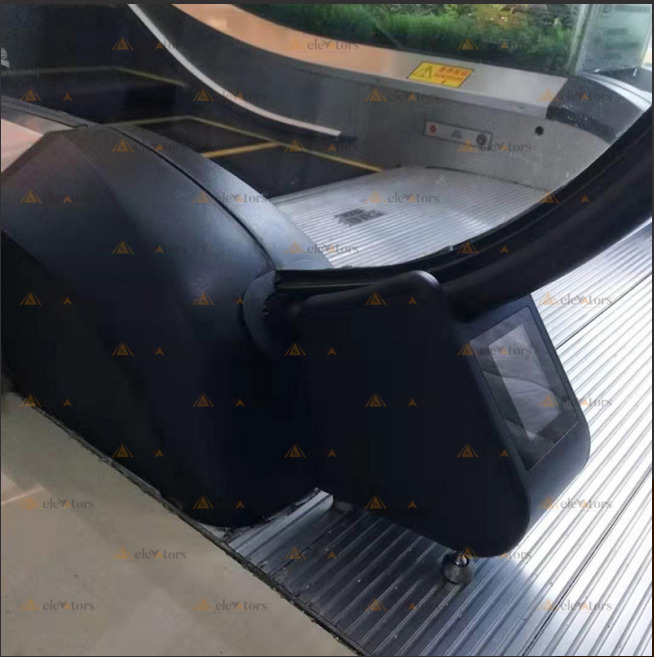

- TECHNICAL PARAMETERS:**
- Product name: LP-750 Escalator Handrail Cleaning Machine
 - Voltage: 12V
 - Battery capacity: 1800mah
 - Pump flow: 1.5L/min
 - Pump size: 90mm*40mm*35mm
 - Pressure: 3mpa Weight: 20Kg

INSTALLATION:
When the automatic step ladder is running upward, the step ladder cleaner must be placed under the step ladder for cleaning, and when the automatic step ladder is running downward, the step ladder cleaner must be placed above the step ladder for cleaning.

Add water to the clean water tank, add disinfectant according to the instructions. Move the machine to the armrest and adjust the swing arm to the appropriate height. First put the lower wrap rubber into the handrail of the escalator, and then put the upper wrap rubber into the handrail.

After inserting, turn on the machine. Into the working state, regular spray disinfection.

ESCALATOR STEP CLEANING MACHINE

GS00101004



INTRODUCTION

Automatic step ladder cleaning machine for cleaning a variety of different escalators, lightweight, folded display, convenient transportation. The machine is equipped with stain brush and a dust collecting device, collector, wiping, cleaning functions, convenience, simple operation. The automatic step ladder cleaning machine is placed in the step ladder run on clean, normally only needs 15 minutes to complete the automatic step ladder cleaning easy, step ladder to restore clean and bright.

USING STEPS:

1. The correct installation of dust bag.
2. The host is placed in the automatic step ladder, pull the armrest.
3. In the automatic step ladder on the other side placed noted on the label.
4. Connect the power.
5. Turn on the switch, the host operation.

MATTERS NEEDING ATTENTION:

Caution: Moving escalator cleaner must be cleaned upon the staircase while moving escalator operates upgrade. Moving escalator cleaner must be cleaned down the staircase while moving escalator operates downgrade.

ESCALATOR CLEANER MACHINE TECHNICAL PARAMETERS

Item No: LP-460

Volume: 20L

Power: 2000W

Voltage: 220V-240V/50HZ

Cable: 15M

Weight: 35KG

Noise: ≤60dba

Safe Standards: level 1

Working Width: 45cm

GESTURE CALL DS00101001



APPLICATION:

The device can be retrofitted on old elevators or new elevator. It is an optional device. It can be access to any brand of elevator, suitable for commercial and domestic elevators.

FUNCTION:

- Incorporate elevator call button without destroying original elevator function and circuit.
- Wave your hands to call the elevator. Without touching the elevator buttons which can effectively avoid contact with bacteria or viruses on the buttons to protect the health of passengers.

OPERATING MODE:

Put your hand 5~15cm away from the “gesture call” device and swing upwards to trigger the “upward” button;
Put your hand 5~15cm away from the “gesture call” and swing it downward to trigger the “downward” button.
It can also be used with gloves.

PRODUCT PARAMETERS:

- **Gesture effective range:** distance 5 ~ 15 cm, angle; horizontally forward of the center of the device, ± 30 degrees
- **Power voltage:** input rated DC12 ~24V
- **Overall power:** 1W (MAX)
- **Working environment temperature:** -20°C~ 60°C
- **Storage temperature:** -20°C~ 70°C

INTERFACE DESCRIPTION:

POWER INTERFACE

Interface model	PH-2.0-2P
PIN pin	Definition
1pin	DC POWER 12 ~ 24V
2pin	GND

DC POWER 12 ~ 24V

Interface model	PH-2.0-4P
PIN pin	Definition
1pin	UP1: Connect the up button cable
2pin	UP2: Connect the up button cable
3pin	DN1: Connect down button line
4pin	DN2: DN1: Connect down button line

Note: The “gesture call” device installed on the top floor only needs to connect the “DN1 DN2” down button line.
The “gesture call” device installed on the ground floor only needs to connect the “UP1 UP2” up button line.

WIRING DIAGRAM:

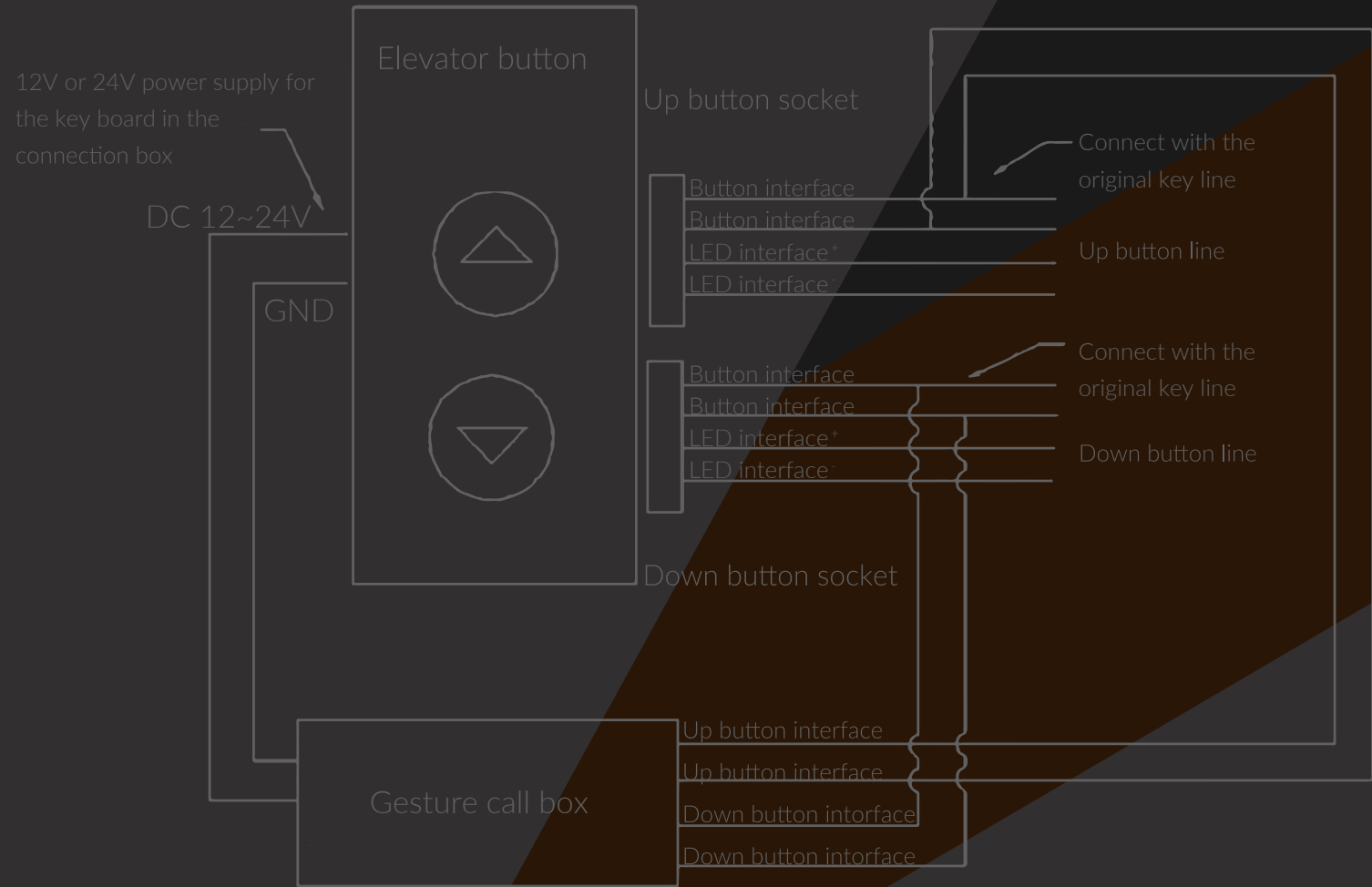

APPEARANCE CHART:

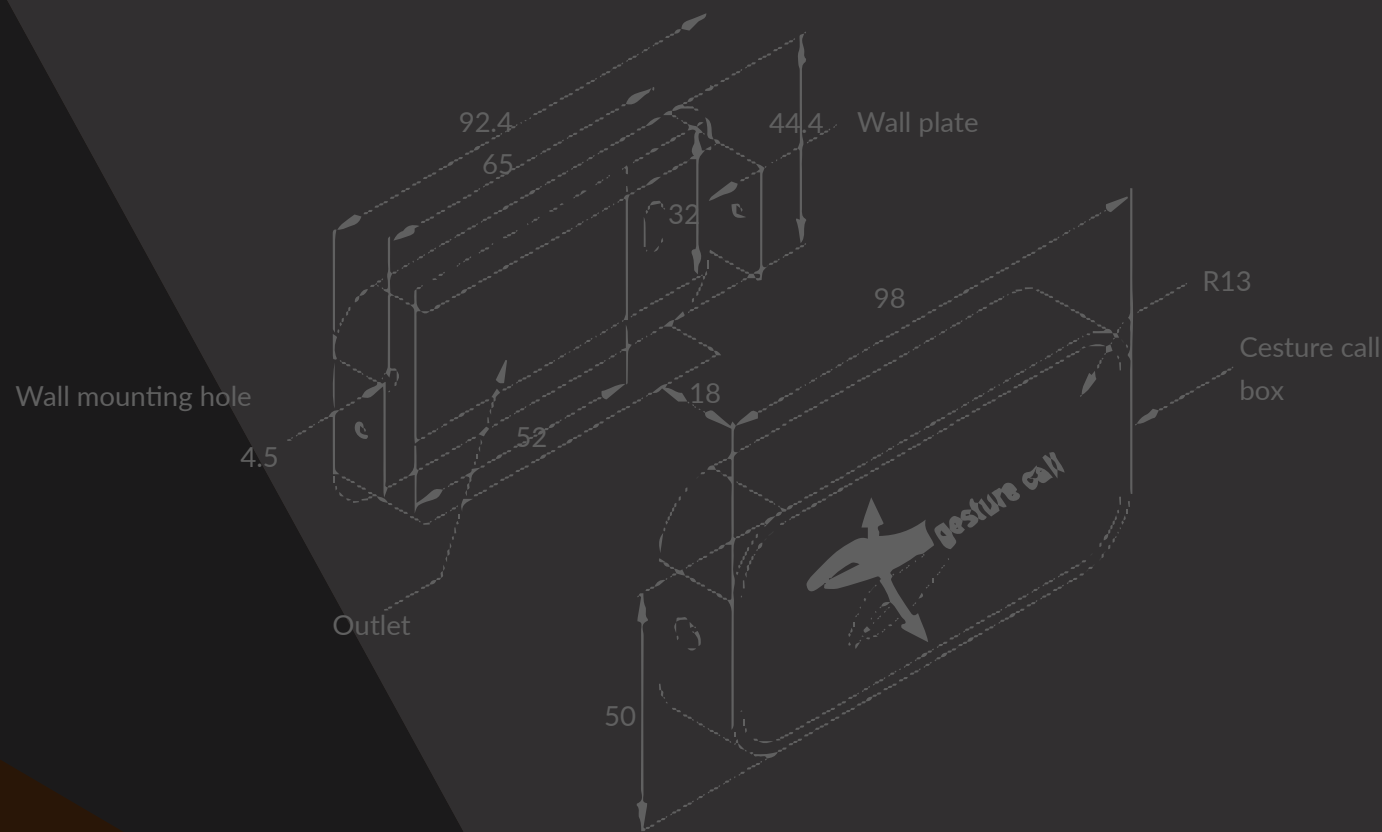

WALL MOUNTING HOLE



USE DESCRIPTION:

GYFB-9B Fan is suitable for sterilizing, disinfecting and purifying air in elevator cars, driving operation rooms, laboratories, etc. The experimental reports proved that:

- The purification efficiency of PM2.5 particles: $\geq 99\%$
- The sterilization and disinfection rate: $\geq 99\%$

TECHNICAL PERFORMANCE

Speed: $1200 \pm 100\text{rpm}$
Noise: $\leq 45\text{db}$
Air volume: $4.8 \pm 0.5\text{m}^3 / \text{min}$

TECHNICAL DATA

Working voltage: AC110/220/230V 50/60HZ A0.09/0.11
Impeller size: φ91X266mm
Air outlet size: 43X270mm
Motor power: 25W
Dimensions: 420X145X132mm
Weight: 3.5 kgs

PRECAUTIONS

- 1. The environment for using the fan should not be too humid, and it is required to be waterproof.
- 2. Do not wash or wipe under working conditions, to prevent personal injury accidents.
- 3. Must be used the fan according to the specifed working voltage to prevent damage the fan.
- 4. If the fan or power cord is damaged, it must be sent to the manufacturer or a professional for repairing and replacing.
- 5. In the fxed wiring where this appliance is installed, all power disconnecting de- vices with a contact opening distance of at least 3mm on the pole must be installed.
- 6. The installation height of fan blades is higher than 2.3 meters.
- 7. When the fan is used for household purposes, please install the motor protective cover.

INSTALLATION DIMENSIONS

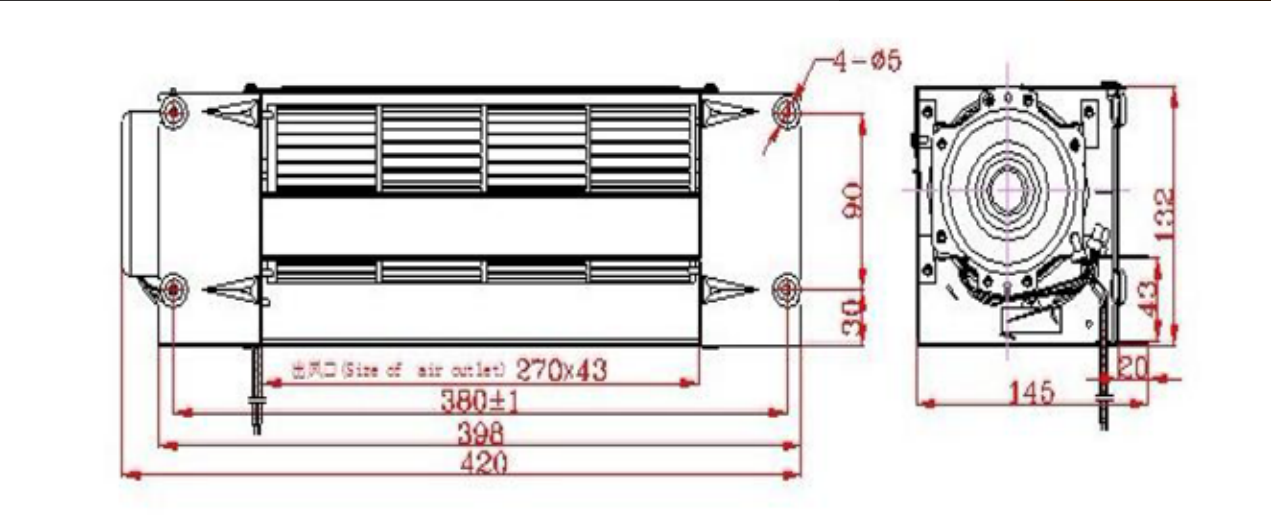

PHOTOS



ELEVATOR PLASMA AIR PURIFIER

DS00101003

ABOUT IONS IN THE AIR

Ions are the charges contained in molecules ro atoms. These ions exist in nature. After the plasma air technology is released, they actively collide and attack each other, inhibit and decompose the bacteria and mold molecules in the air, and destroy their particles. And foating mold, etc., will form a cluster of grape clusters, so that you can always be in the pollytion-free original ecologi- cal environment, always breathe fresh and clean air similar to nature, it is very comfortable. This is the basis of plasma air technology. Break down the cell wall membrane.



IONS IN DIFFERENT LOCATIONS

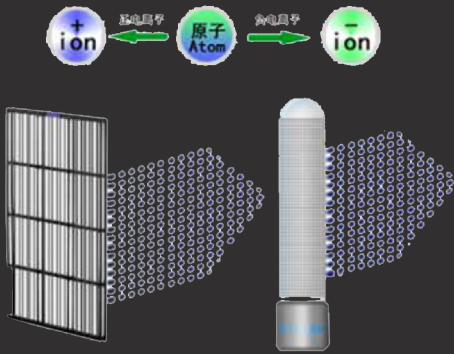

INDOOR CITY COUNTRY
MOUNTAINFOREST
WORKING PRINCIPLE

DEYSSE has a specially provided plasma conversion tube that uses a specific voltage to convert electrons in the atomic atoms of the air into charged ions. When the air passes through the ionization tube, it will form millions of

positive ions and negative ions, simulating the air environment in the natural mountain-ous area, which makes the indoor air fresh and effective in solving indoor air pol- lution problems.

APPLICATION ANALYSIS:

In crowded high-speed trains, subways, buses and long-distance buses, Crowd, air difficult to circulate pollutants are easily “trapped” in the car (help Hands, backrest, seate, windows and frequently touched places) are extremely easy to cause Cross infection, human body from respiratory tract, digestive- tract, skin, hair, etc Produce bacteria and peculiar smell, cough, sneeze, etc. Pollution is worse than others Public places are more serious. Active plasma air purification technology can effectively prevent and control in the air (aerosol) infetious disease transmission, bacteria, viruses, differences Taste, etc. are decomposed to kill and clean the air.



PRODUCT PARAMETERS
NO.DS00101003

SPECIFICATIONS

Design air volume	60m3/h
Applicable area	20 - 30m2
Shell material	Aluminum alloy
Weight	1 kg
Extreme operating temperature	+60°C -20°C

ELECTRICAL

Voltage	DC 12V
Frequency	50/60Hz
Power consumption	10W
Internal fuse	Overload Safety Protection
Design and Dual Protection of Power Supply	

IONIC VALVE

Material	Multiple compsite,
staninless stell outer net	
Quantity	Two
Size	70mm (3-inch standard)
Ion tube life	2 years
Size	See Figure 2

CERTIFICATE

CE certification, CMA certification, CNAS certification



- 1 air intake
- 2 Outlet
- 3 power plug
- 4 Fuse
- 5 Power switch
- 6 Work indicator
- 7 Primary filter screen (clean once every 3-6 months)

W: 60m m



L: 175m m

H: 260m m

ELEVATOR AIR STERILIZER DS00101004



PRODUCT OUTLINE

- Double functions of highly efficient disinfection and purification
- All-round disinfection and purification of elevator air and walls
- Peaceful coexistence of human and machine to realize real-time disinfection and purification

- Ultrathin design for easy installation and maintenance
- Intelligent biological recognition
- Internet of Things optional

EXTERNAL DIMENSION

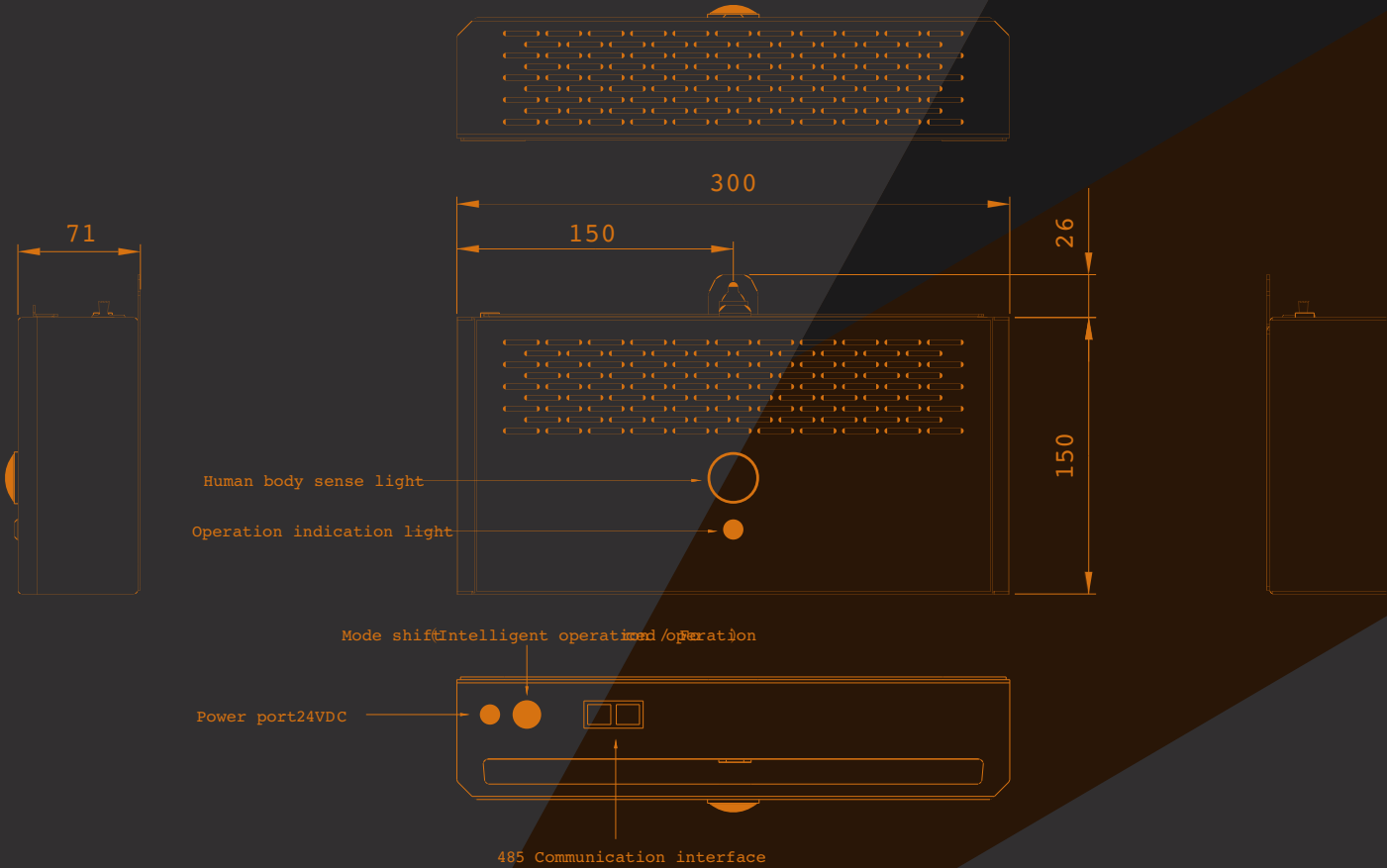

PERFORMANCE PARAMETER

1	Circulating air volume	60m3/h @0Pa
2	Disinfection bacteria-killing technology	Germagic slow-released molecules + wholly-closed UV photo catalyst
3	Disinfection efficiency	99%
4	Killing rate of virus(influenza A and B virus)	99%
5	Killing rate of MERS coronavirus	98%
6	Noise	45dB(A)@1m
7	Way of air flow-in and flow out	Breathe in from bottom and return from front
8	Rated voltage of adaptor	220V 50/60Hz
9	Max operation current	1.2A(24V DV)
10	Output voltage of adaptor(connecting to product)	24V DC
11	Rated power	15W
12	Standby power	3W
13	Range of working temperature	-20°C-45°C
14	Range of working humidity	Relative humidity from 5% to 95%
15	Maintenance requirement	Top maintenance of filter
16	Maintenance period(Germagic slow release molecular filter)	90 days(normal)
17	Maintenance period(UV photo catalyst assembly)	360 days
18	External dimension(width×height×thickness)	300*150*66mm
19	Net weight	1.6KG

Lab Test Result

VIRUS				BACTERIA				MDROs			
Type	Killing rate	killing time (min)		Type	Killing rate	killing time (min)		Type	Killing rate	killing time (min)	
H1N1 swine flu & H1N1	>99.9%	1		Mycobacterium tuberculosis	>97%	0		MRAS	>99.9%	1	
Influenza B	>99%	1		Legionella pneumophila	>99.9%	1		MR PA	>99.9%	1	
H3N2	>99%	1		Staphylococcus aureus	>99.9%	1		VR E	>99.9%	1	
H7N9	>99.9%	1		Aspergillus niger	>99.9%	1		Imipenem-resistant	>99.9%	1	
NOVs, Measles	>99.9%	1		Candida albicans (fungus)	>99.9%	1		Acinetobacter			
EV71	>99%	1		Coliform bacteria	>99.9%	1					
MERS-CoV	>98%	60		Bacillus pneumoniae	>99.9%	1					
				More than ten other strains	>99%						

Complete security test

No heavy metal, no poison	Mental corrosion test	several skin irritation test	Vagina mucosa irritation test	Mutagenesis test	Acute toxicity Inhalation test	Acute oral toxicity test	Acute eye irritation test	Identification of non-dangerous goods	Hygiene security test	

ELEVATOR ULTRAVIOLET DISINFECTION SYSTEM DS00101005

FUNCTION

UV disinfection lamp's light wave is 254nm (no ozone), so the sterilization efficiency can reach 99%.



SMART CONTROL

1. Obtain the elevator signal, turn on or turn off the UV disinfection lamp when no one use the elevator. And turn off the UV disinfection lamp immediately when someone uses the elevator.
2. It is equipped with the infrared motion sensor light controller, which is the protection device, when people (or other living thing) is sensed, do not turn on or stop the operation of the ultraviolet disinfection immediately to ensure safety.
3. Clock function. It can turn on or turn off the ultraviolet disinfection lamp regularly.
4. Cumulative statistics time of use the lamp, life expiration, lamp replacement reinder.
5. PC software settings on the anti-virus, waiting time parameters, time setting, etc. U disk connection is automatically updated to the control box.
6. Bluetooth connection, non-contact control system, update anti-virus time settings, view current status, synchronization time, etc.

APPLICATION

For the new elevator, ultraviolet disinfection system can be standard or optional. Access to any major brand elevator, suitable for commercial and residential elevators.

PRODUCT PARAMETERS

Controller

1. Working voltage: 220V AC
2. Working current: 200mA (MAX)
3. Rated power: 5W
4. USB interface: USB2.0
5. Network RJ45 (optional)
6. Bluetooth 5.0 (optional)
7. Elevator signal connection: cable connection (with lug added)
8. Working temperature: -20°C ~ 60°C
9. Storage temperature: -20°C ~ 70°C

INFRARED MOTION SENSOR LIGHT CONTROLLER

1. Working voltage: AC 220V
2. Working frequency: 50Hz
3. Induction mode: human infrared movement
4. Detection range: 360°/ 120°
5. Detection distance: 3~5m
6. Delay connection duration: 16 ~ 360 seconds (adjustable)
7. Light control sensor: 5-500LUX (adjustable)

UV DISINFECTION LAMP

1. Power: 10W, 20W, 30W, 40W
2. Voltage: AC 185 ~ 245V 50Hz
3. Working temperature: -10°C - 60°C, Ambient temperature: 5°C- 40°C
4. Rated life: 8000 hours
5. Luminous flux maintenance rate during the lifetime: 80%
6. Working mode: continuous operation
7. Ultraviolet spectrum: 253.7nm (commonly known as 254nm)

WIRING DIAGRAM

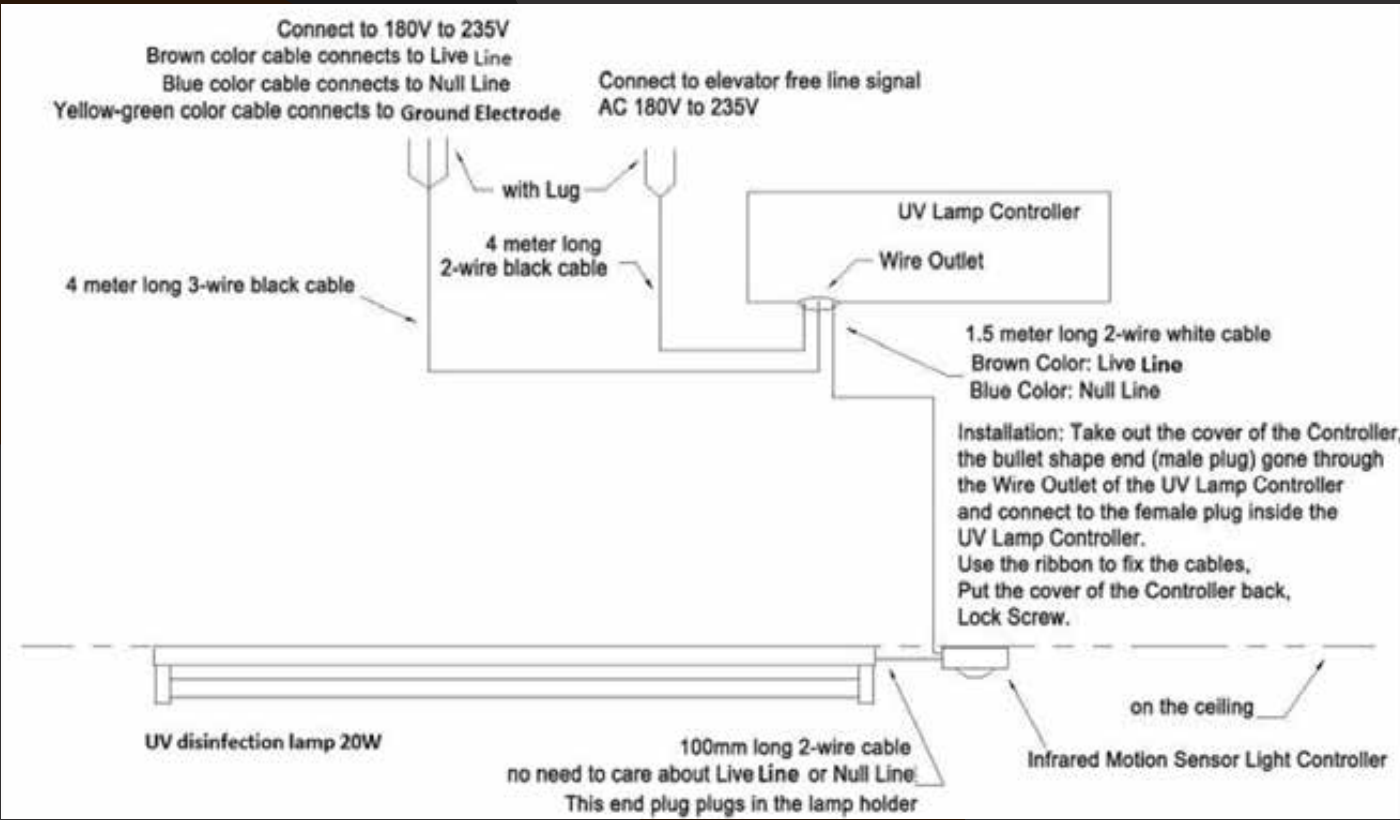

PRODUCT APPEARANCE

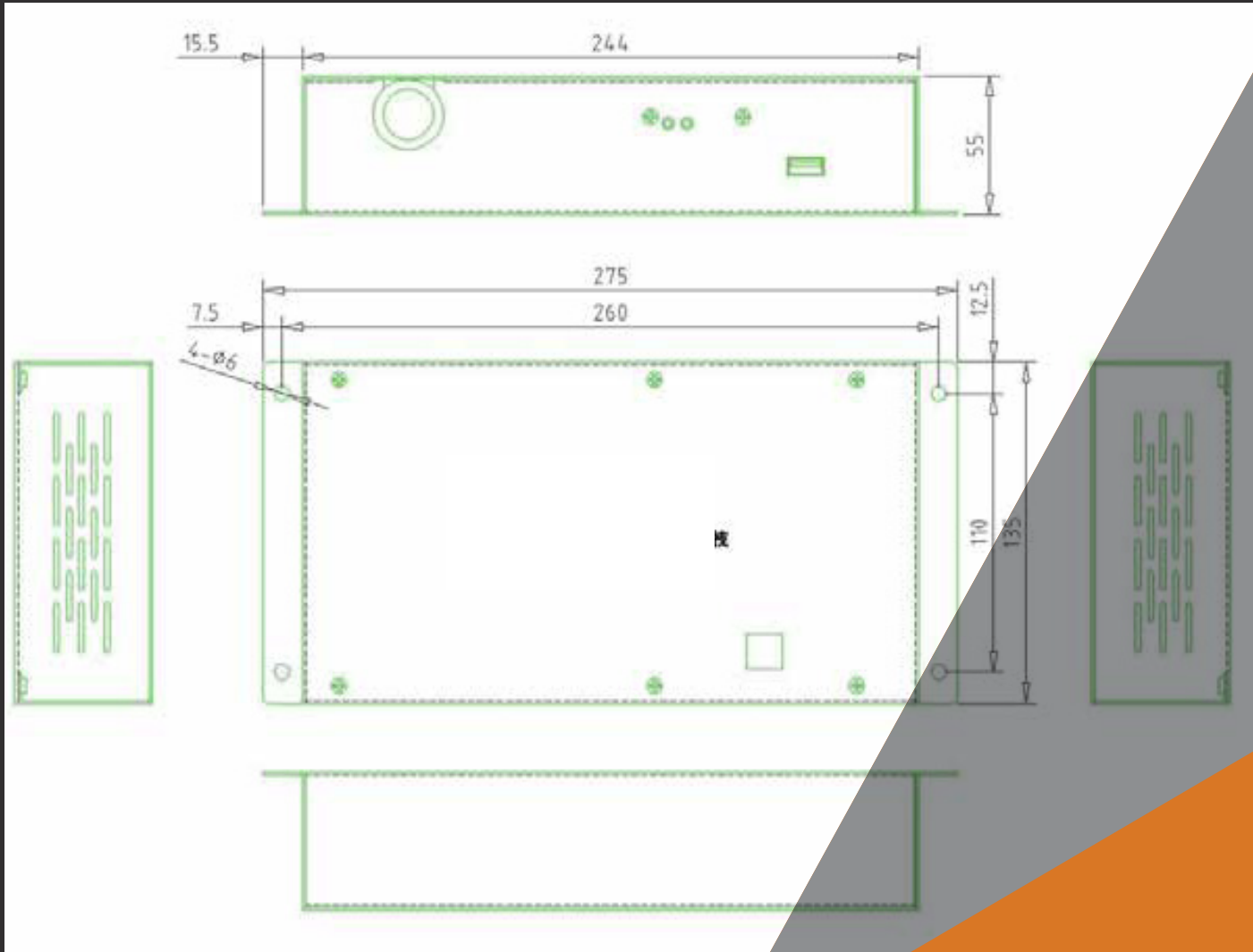

SGS-CSTC Standards Technical Services Co., Ltd.
Guangzhou Branch

198 Kezhu Road, Sciencetech Park, Guangzhou Economic & Technological
Development District, Guangzhou, China 510663
Telephone: +86 (0) 20 82155555
Fax: +86 (0) 20 82075058
Email: ee.guangzhou@sgs.com

Page 1 of 1

VERIFICATION OF EMC COMPLIANCE

Verification No.: GZEM2005012728HSV
Applicant: GUANGZHOU DEYSSE ELEVATOR FITTINGS CO.LTD
Address of Applicant: Room 2801-01, Jinhui Building, No.123 Jiefang South Road,
Yuexiu District, Guangzhou, 510120 China
Manufacturer: The same as applicant
Address of Manufacturer: The same as applicant
Factory: The same as applicant
Address of Factory: The same as applicant
Product Description: Elevator Air Sterilizer
Model No.: DS00101004
Trade Mark: deysse
Sufficient samples of the product have been tested and found to be in conformity with
Test Standard(s): EN 61000-6-3:2007 +A1:2011
EN IEC 61000-6-1:2019

As shown in the
Test Report Number(s): GZEM200501272801

This verification of EMC Compliance has been granted to the applicant based on the results of the tests, performed by laboratory of SGS-
CSTC Standards Technical Services Co., Ltd. on the sample of the above-mentioned product in accordance with the provisions of the
relevant specific standards under Directive 2014/30/EU.

The CE mark as shown below can be used, under the responsibility of the manufacturer, after completion of an EU Declaration of
Conformity and compliance with all relevant EU Directives.

Kobe Jian

Kobe Jian
EMC Laboratory Manager



Date: 2020-06-16



SGS-CSTC Standards Technical Services Co., Ltd.
Guangzhou Branch
No.198 Kezhu Road, Sciencetech Park, Guangzhou Economic & Technological Development District, Guangzhou, China 510663
t (86-20) 82155555 f (86-20) 82075058 www.sgs.com.cn
中国·广州·经济技术开发区科学城科珠路198号 邮编: 510663 t (86-20) 82155555 f (86-20) 82075058 sgs.china@sgs.com

Unless otherwise agreed in writing, this document is issued by the Company subject to its General Conditions of Service printed
overleaf, available on request or accessible at <http://www.sgs.com/en/Terms-and-Conditions.aspx> and, for electronic format documents,
subject to Terms and Conditions for Electronic Documents at <http://www.sgs.com/en/Terms-and-Conditions/Terms-e-Document.aspx>.
Attention is drawn to the limitation of liability, indemnification and jurisdiction issues defined therein. Any holder of this document is
advised that information contained hereon reflects the Company's findings at the time of its intervention only and within the limits of
Client's instructions, if any. The Company's sole responsibility is to its Client and this document does not exonerate parties to a
transaction from exercising all their rights and obligations under the transaction documents. This document cannot be reproduced
except in full, without prior written approval of the Company. Any unauthorized alteration, forgery or falsification of the content or
appearance of this document is unlawful and offenders may be prosecuted to the fullest extent of the law. Unless otherwise stated the
results shown in this test report refer only to the sample(s) tested and such sample(s) are retained for 30 days only.

Attention: To check the authenticity of testing / inspection report & certificate, please contact us at telephone: (86-755) 8307 1443,
or email: CN.Doccheck@sgs.com

Member of the SGS Group (SGS SA)

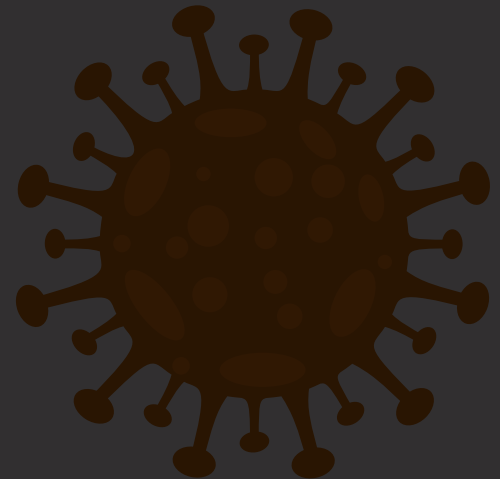
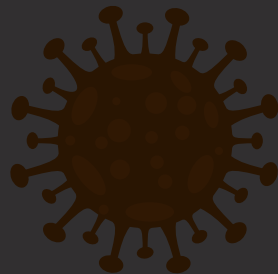
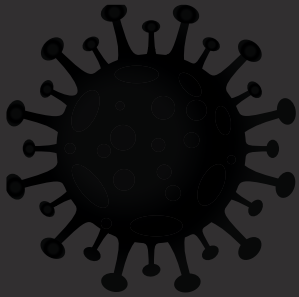

CONTACT:

info@kelevators.co.za

Tel:

010 133-2222

0812705865

Address:

56 Von Wielligh Street, Johannesburg, 2001 Clinix Building 6th Floor